

Toll Free: 800-761-7264  
Fax: 855-855-7681  
<http://www.vestamodular.com>  
[info@vestamodular.com](mailto:info@vestamodular.com)



## 10' x 44' Office

### Building Details:

Asset #: MO00038  
State Seal: FL/AL/GA  
Building Size: 10 x 44  
Square Footage: 440  
Occupancy: B-Business  
Roof Load: 20 PSF  
Wind Load: 130 MPH  
Floor Load: 50 PSF  
Electrical: 1 Phase / 125 AMP / 120/240  
Volt

### Exterior Details:

Siding Material: .Hi-Rib Steel  
Roofing Material: .045 Black EPDM  
Frame: Outrigger  
Windows: 6  
Doors: 2  
HVAC: 2.5 Ton with 10KW Heat Strip

### Interior Details:

Wall Finish: VCG  
Floor Finish: Black Tile  
Lighting: Fluorescent  
Restrooms: 1  
Ceiling: Hard

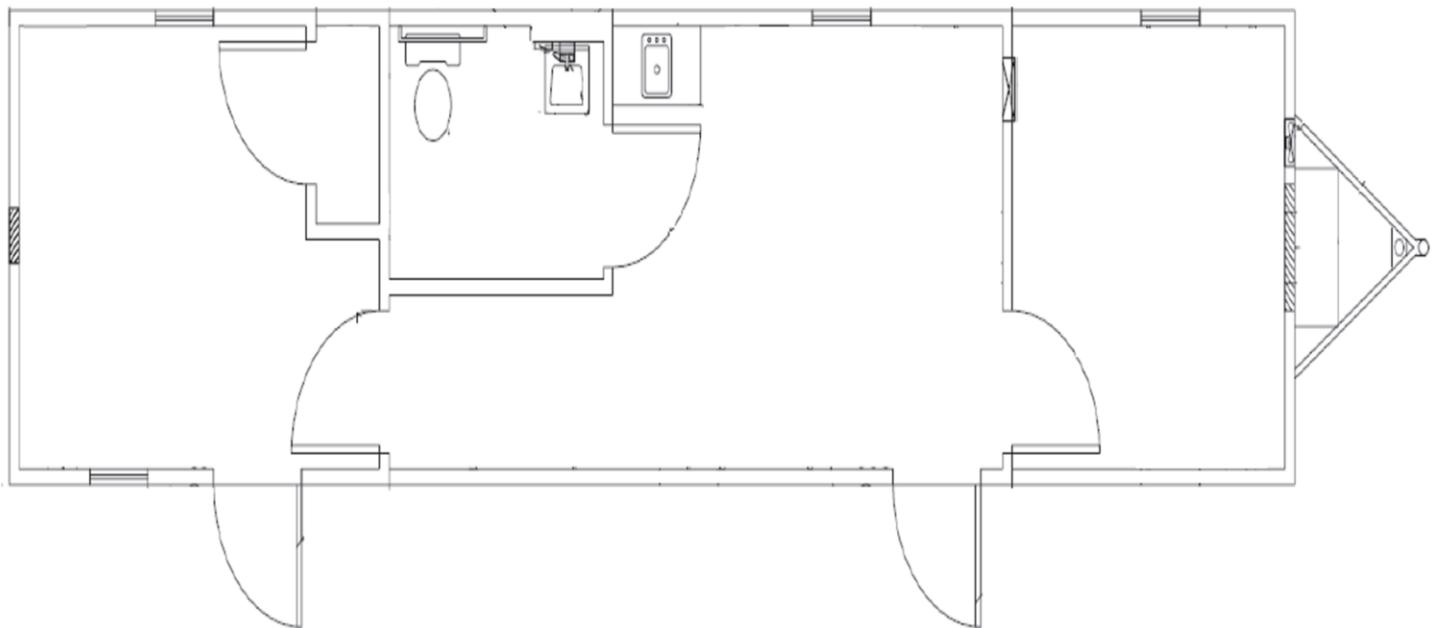

\*\*This building is subject to availability. The details provided are for informational purposes only and are not guaranteed. For detailed specifications, drawings and pricing contact your local representative.