

Toll Free: 800-761-7264  
Fax: 855-855-7681  
<http://www.vestamodular.com>  
[info@vestamodular.com](mailto:info@vestamodular.com)



## 24' x 56' Office

### Building Details:

Asset #: MO00035  
State Seal: GA  
Building Size: 24' x 56'  
Square Footage: 1344  
Occupancy: B - Business  
Roof Load: 20 PSF  
Wind Load: 130 MPH  
Floor Load: 50 PSF  
Electrical: Single Phase / (2) 100 AMP Panel / 120/240 Volts

### Exterior Details:

Siding Material: .019 Aluminum  
Roofing Material: .045 EPDM  
Frame: Outrigger  
Doors: (2) Single  
Windows: (8) Vertical Slide  
HVAC: (2) 3 Ton / 10 kw Heat Strip

### Interior Details:

Wall Finish: .019 Aluminum  
Floor Finish: Carpet / Tile  
Lighting: Fluorescent  
Ceiling: Hard (Seaspray)  
Restroom: (2) Single -Stall

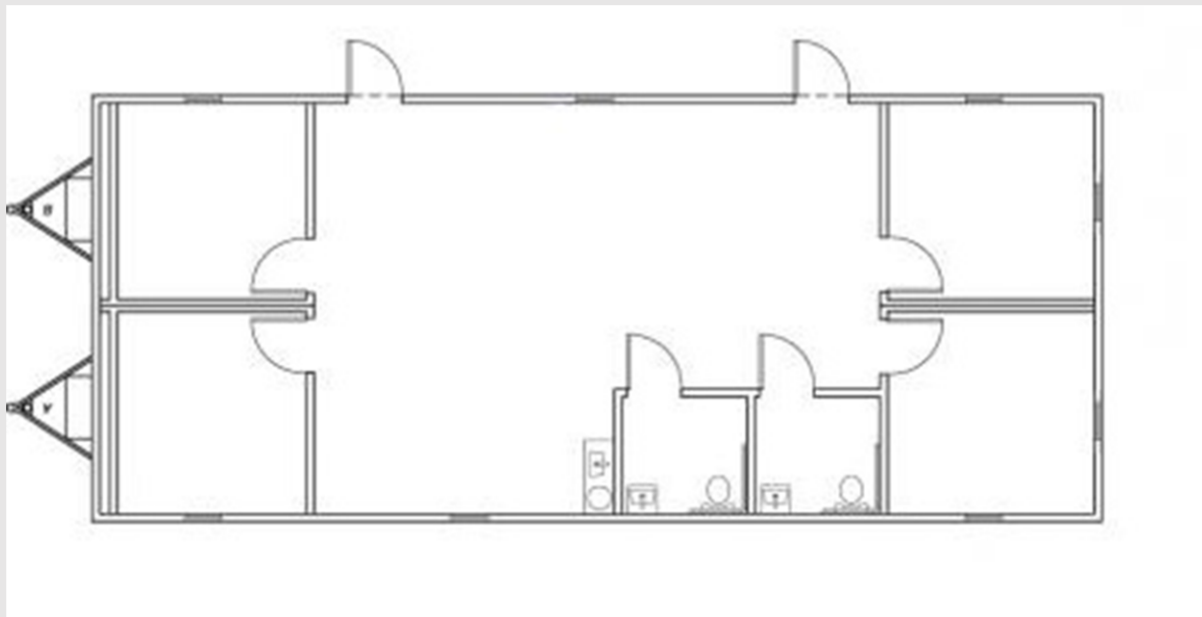

\*\*This building is subject to availability. The details provided are for informational purposes only and are not guaranteed. For detailed specifications, drawings and pricing contact your local representative.