

Toll Free: 800-761-7264
Fax: 855-855-7681
<http://www.vestamodular.com>
info@vestamodular.com



24' x 64' Classroom

Building Details:

Asset #: CR00379
State Seal: TX, LA, OK
Building Size: 24 x 64
Square Footage: 1536
Occupancy: E - Education
Roof Load: 20 PSF
Wind Load: 130 MPH
Floor Load: 50 PSF
Electrical: Single Phase / 200 AMP Panel / 120/240 Volts

Exterior Details:

Siding Material: 26 Gauge Hi Rib Steel
Roofing Material: 26 Gauge Galvalume Steel
Roofing
Frame: Outrigger
Doors: (2) Single
Windows: (4) Horizontal Slide
HVAC: (2) 3 Ton / 10 kw Heat Strip

Interior Details:

Wall Finish: Vinyl Covered Gypsum
Floor Finish: Tile
Lighting: Fluorescent
Ceiling: T-Grid

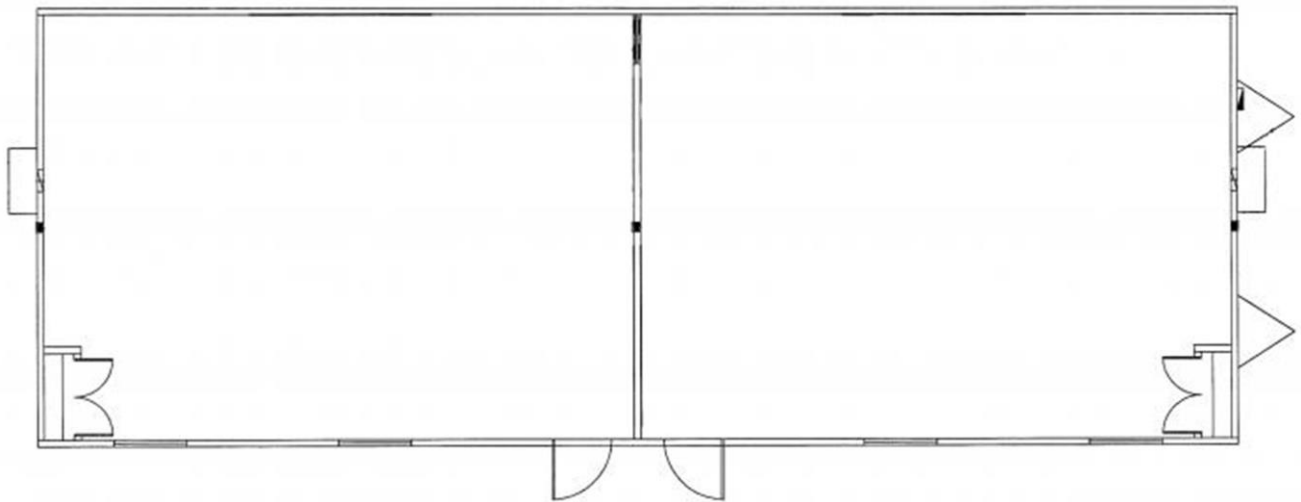

**This building is subject to availability. The details provided are for informational purposes only and are not guaranteed. For detailed specifications, drawings and pricing contact your local representative.