

Toll Free: 800-761-7264
Fax: 855-855-7681
<http://www.vestamodular.com>
info@vestamodular.com



68' x 164' Classroom

Building Details:

Asset #: CR00504
Storage: Rayne, LA
Building Size: 68.00ft. x 164.00ft.
Square Footage: 11,152 Sq. ft.
Occupancy: Education
Roof Load: 30psf
Wind Load: 130mph
Floor Load: 40psf
Electrical: Single Phase / 200 AMP Panel / 120/240 Volts

Exterior Details:

Siding Material: High Rib Steel
Roof Material: .45 EPDM
Frame: Perimeter
Doors: (2) Double
Windows: (12) Vertical Slide
HVAC: (13) 3 Ton with 10 kw Heat Strip

Interior Details:

Wall Finish: VCG
Floor Finish: VCT
Lighting: Fluorescent
Ceiling: T-Grid

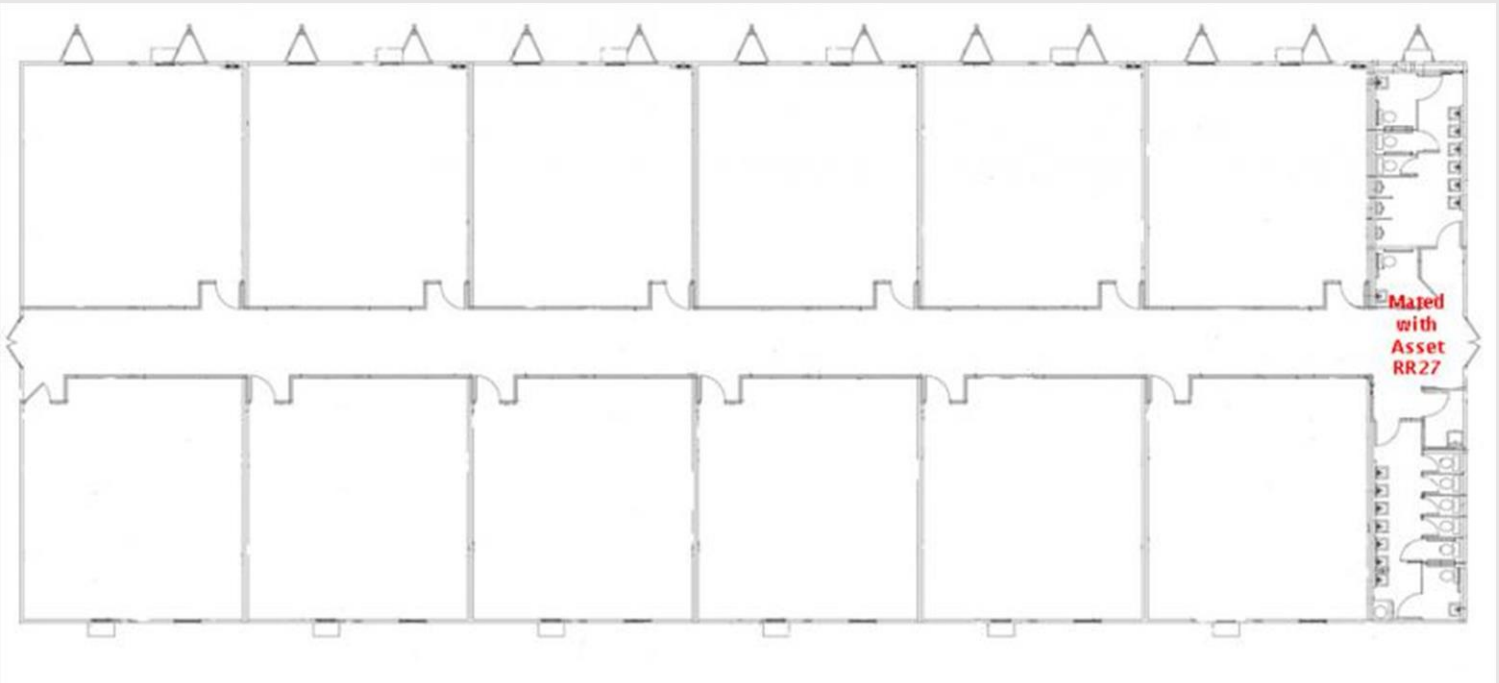

**This building is subject to availability. The details provided are for informational purposes only and are not guaranteed. For detailed specifications, drawings and pricing contact your local representative.